



# NAN (M8) Series Receptacles

3 & 4 Conductor NAN Series Receptacles, 24AWG



Front & Back Mount Receptacles | 1/2"-14 NPT & M8 Threads | 60V, 3A | IP67 Rating

# of Poles	Male Faceview	Color Code	Wire AWG Rating	Thread Type	Male Receptacles	Female Receptacles
3	 M8 x 1	1. Brown 2. Not Used 3. Blue 4. Black	24 AWG  60V 3A	1/2" NPT	NAN-T-3MR-2	NAN-T-3FR-2
				M8 x 0.5	NAN-T-3MR-M8	NAN-T-3FR-M8
				Back Mount	NAN-T-3MR-BM	N/A
4	 M8 x 1	1. Brown 2. White 3. Blue 4. Black	24 AWG  60V 3A	1/2" NPT	NAN-T-4MR-2	NAN-T-4FR-2
				M8 x 0.5	NAN-T-4MR-M8	NAN-T-4FR-M8
				Back Mount	NAN-T-4MR-BM	N/A

12" leads are standard. Longer lead lengths are available, please consult the factory for part numbers.  
For 1/2" receptacles with lengths of 15" or longer O-ring and lock nut are included.

## 1/2" NPT Threads

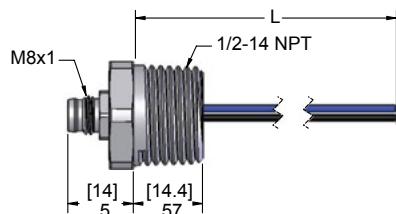

Male Receptacle

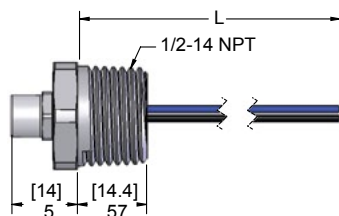

Female Receptacle

## M8 Threads

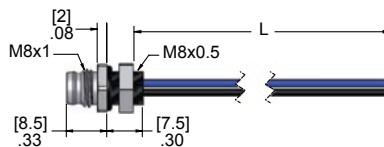

Male Receptacle

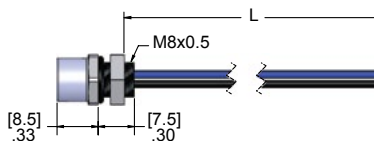

Female Receptacle

## Back Mount

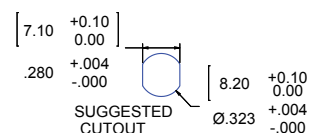
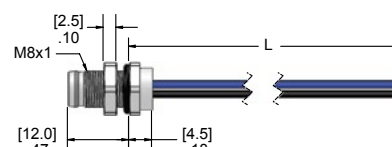

Male Receptacle

## Specifications:

Shell:	Nickel Plated Brass
Insulator:	Polyamide
Contacts:	Copper Alloy with Gold Plating
Wires:	24 AWG
O-Ring:	NBR
Lock Nut:	Zinc Plated Steel
Jam Nut:	Nickel Plated Brass
Temperature:	-25°C to +90°C (-13°F to +194°F)