



# Panel Interface Connectors

## Port Adapters



Single Port Shell | Back Mount | UL Type 12 | IP65, IP69 Rating



Part Number	Description	Front	Back	M20 Cutout
USB-AFAM-BM-**	USB Female TYPE A to Male TYPE A			

\*\* Length in meter. Standard cable lengths are 0.5, 1, 2 & 3 meters. Consult factory for other lengths.

### Specifications:

Body: Black ABS  
Gasket: Black TPE  
Jam nut: Black ABS  
Tightening Torque: 3.5 N-m  
Max. Panel Thickness: 7.5 mm

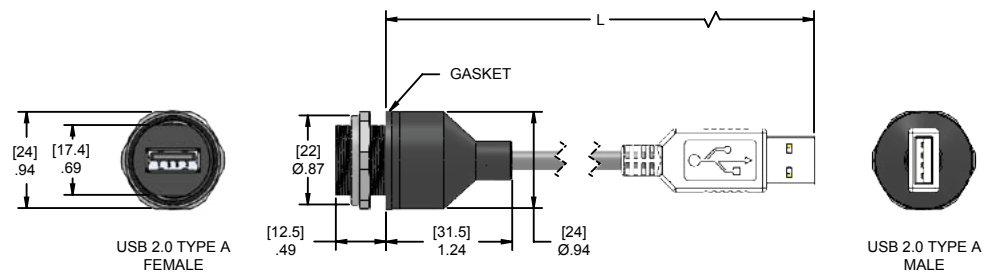

For M20 Cutout

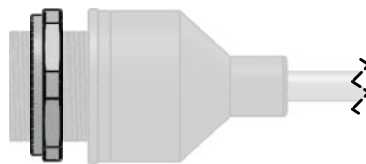

For M22 Cutout

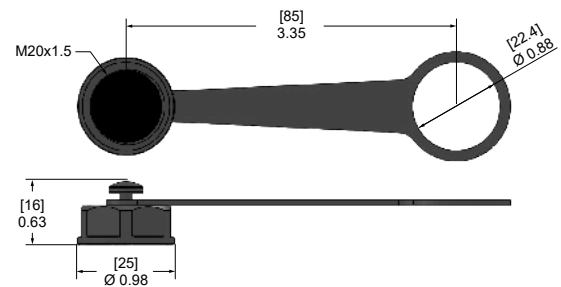
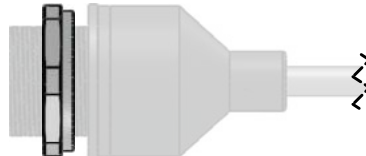

Cap (CAP-M20-PASW-M22T) included.

By flipping over the included jam nut, this port adapter will fit into an M22 cutout.