

**RJ45 male 0° / RJ45 male 0° Gigabit**

TPE 4x2x26AWG SF/UTP CAT6a bu UL/CSA, CMR 1,5m

Ethernet CAT6A  
Male straight – male straight  
RJ45 – RJ45, 8-pole  
without cable sleeves  
shielded  
Protection cap  
Further cable lengths on request.  
Plastic housings with good resistance against chemicals and oils.  
The resistance to aggressive media should be individually tested for your application. Further details on request.

[Link to Product](#)

Illustration

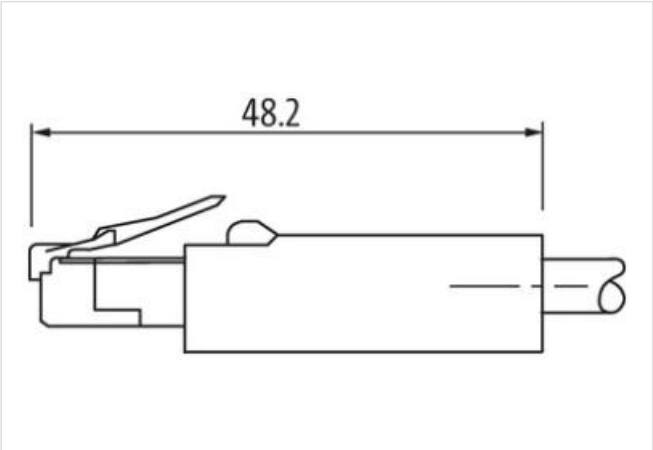
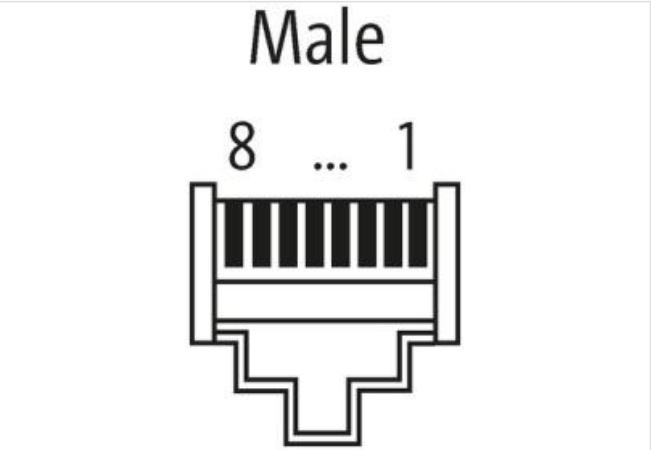
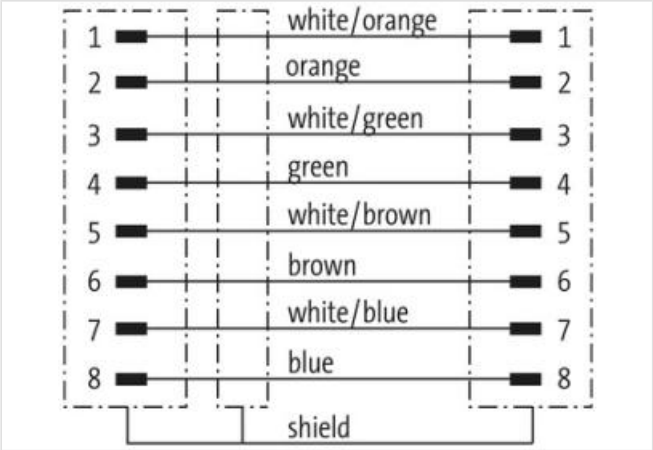
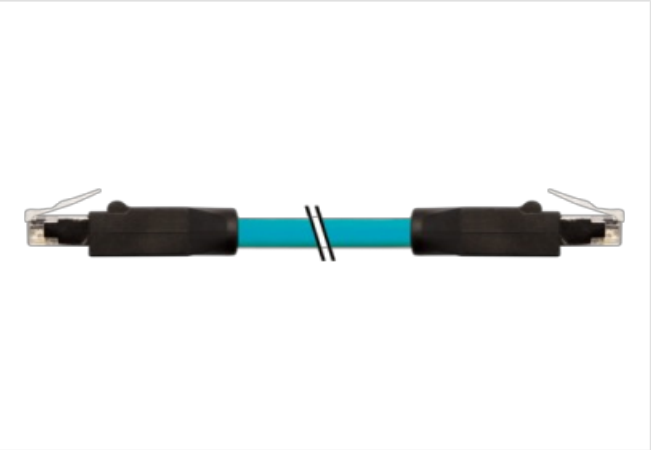

Product may differ from Image

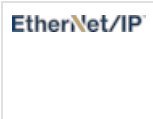
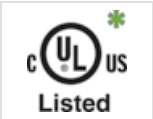

\* only for products with UL/CSA approved cable

Form

Form 74315

| Technical Data                            |   |
|---|---|
| Operating voltage                         | max. 60 V DC  |
| Operating voltage (only UL listed)        | 30V DC  |
| Rated surge voltage                       | 1.0 kV  |
| Operating current per contact             | max. 1.76 A   |
| No. of poles                              | 8   |
| Transfer parameters                       | CAT6, Class EA (ISO/IEC 11801:2002), (EN 50173-1)     |
| Transfer rate                             | 10 Gbit/s   |
| Material group                            | IEC 60664-1, category I                               |
| LED display                               | no  |
| Locking of ports                          | Snap-in connector                                     |
| Protection                                | IP20 inserted and tightened (EN 60529)                |
| Material                                  | PUR   |
| Locking material                          | PA  |
| suitable for corrugated tube (internal Ø) | without   |
| Configuration                             | fully used  |
| General data                              |   |
| Mounting method                           | inserted, tightened                                   |
| Pollution Degree                          | 3   |
| Temperature range                         | -25...+85 °C, depending on cable quality              |
| Cables                                    |   |
| Cable identification                      | S4X   |
| Approval (cable)                          | UL (AWM-Style 2463/11547), CSA                        |
| Cable weight [g/m]                        | 65,48 g   |
| Material (wire)                           | Cu wire, tin plated                                   |
| Resistor (core)                           | max. 140 Ohm/km                                       |
| Single wire Ø (core)                      | 0.16 mm   |
| Construction (core)                       | 7× 0.16 mm  |
| Diameter (core)                           | 4× 2× 0.14 mm <sup>2</sup>                            |
| Material (wire isolation)                 | HDPE  |
| Wire-Ø incl. isolation                    | 0.9 mm ±5%  |
| Color/numbering of wires                  | (wh-bl, bl) + (wh-or, or) + (wh-gn, gn) + (wh-br, br) |
| Shield                                    | yes   |
| Shield (Type)                             | Copper braid  |
| optical shield cover                      | min. 75%  |
| Material (jacket)                         | TPE   |
| Outer-Ø (jacket)                          | 7.4 mm ±5%  |
| thermal resistance                        | flame retardant                                       |
| Nominal voltage                           | 600 V   |
| Test voltage                              | max. 1.5 kV AC (2s)                                   |
| Temperature range (fixed)                 | -40...+80 °C  |
| Temperature range (mobile)                | -20...+80 °C  |
| Bend radius (fixed)                       | 5× outer Ø  |
| Bend radius (moving)                      | 10× outer Ø   |
| Travel speed (C-track)                    | max. 1.2 m/s  |
| Acceleration (C-track)                    | max. 2.4 m/s <sup>2</sup>                             |
| No. of torsion cycles                     | max. 3 Mio. (25 °C)                                   |
| Torsion speed                             | 60 cycles/min   |
| Product article number of manufacturer    | 7700-74315-S4X0150                                    |
| Cable length                              | 1,5 m   |