

M12 female 90° 3LED IDC V2A

4-pol., 0.25...0.5mm²

F&B
Female 90°
M12, 4-pole
3× LED (PNP)
IDC terminals
Connection cross section: 0.25...0.5 mm²
V2A nut/screw

Plastic housings with good resistance against chemicals and oils.
The resistance to aggressive media should be individually tested for your application. Further details on request.

[Link to Product](#)

Illustration

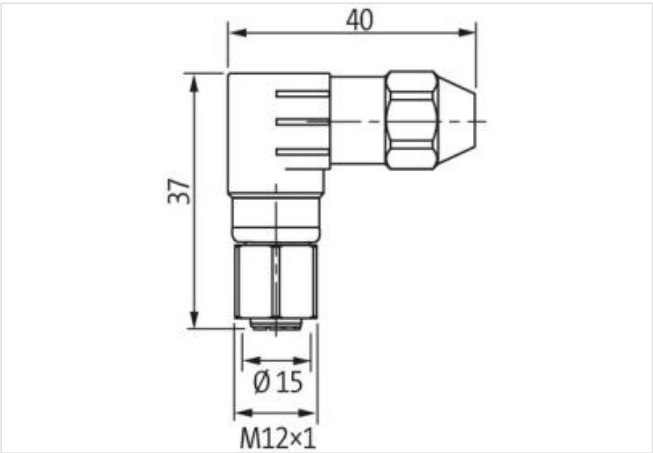
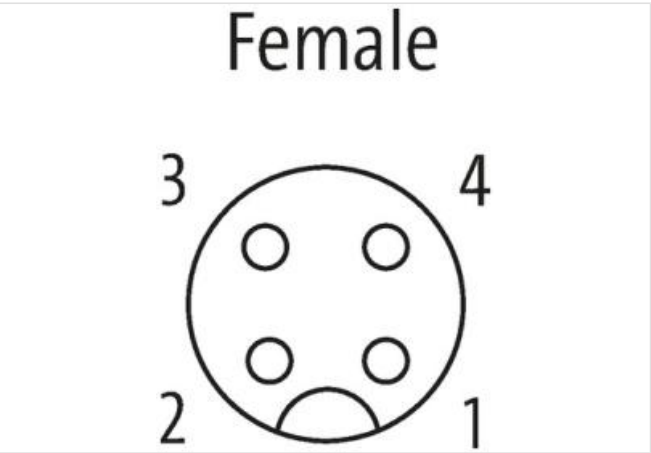
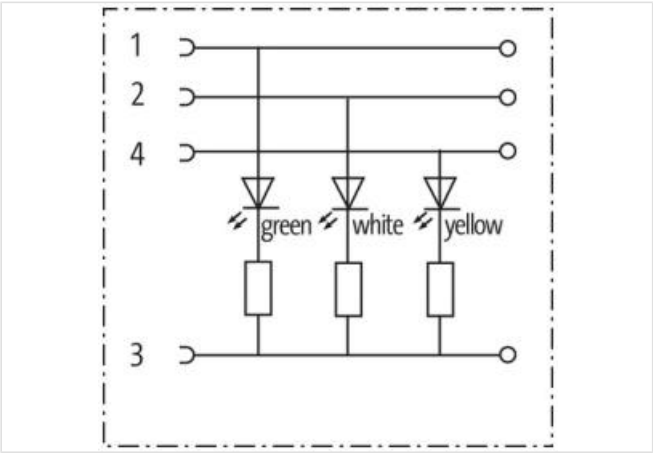

Product may differ from Image

Form

Form 12691

Technical Data

Operating voltage	24 V AC/DC ±25%
Operating current per contact	max. 4 A
Locking of ports	Screw thread (M12×1 mm) recommended torque 0.6 Nm, self-securing

Connection cross section	0.25...0.5 mm ² (conductor diameter min. 0.1 mm)
Sealing range (cable Ø)	4...5.1 mm
Protection	IP67 inserted and tightened (EN 60529)
Locking material	Stainless steel 1.4305 (V2A)
Outer wire Ø	1.2...1.6 mm

General data

Temperature range	-25...+85 °C
Product article number of manufacturer	7002-12691-0000000