

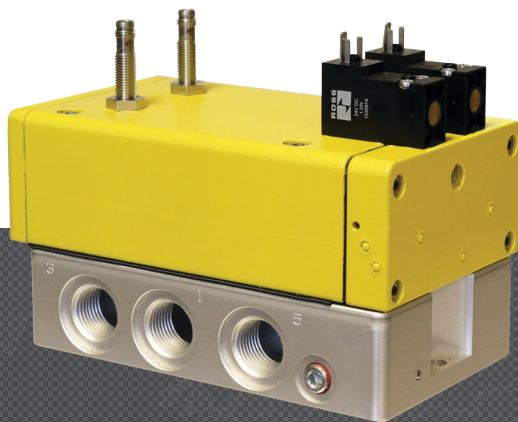

SAFE RETURN DUAL PRESSURE 5/2 DOUBLE VALVES

RSe SERIES

PRODUCT CATALOG



5/2 Control Reliable Double Valves Safe Return Dual Pressure RSe Series

Product Overview

Safety Function

The RSe Series valve safety function is to return the cylinder/actuator to its home “safe” position whenever a fault occurs within the valve.



The 5/2 RSe Series valve can be utilized for Safe Return Dual Pressure Applications to control pressure in order to extend a cylinder with the supply pressure at port 3 and retract with the supply pressure at port 5. The fail-to-safe condition is also to retract. The safety function of the 5/2 RSe Series safe return dual pressure valve is to return the cylinder/actuator to its home “safe” position whenever a fault occurs within the valve by supplying pressure from port 5 to port 4 with port 2 being exhausted out of port 1 and the pressure supplied to port 3 is blocked. Using the RSe valve in a Safe Return Dual Pressure Application can reduce overall air consumption of a machine, and helps protect the environment. However, the RSe Series does this with the same level of control, up to Category 4, PL e, expected of the machine’s/system’s safety circuit.







The RSe Series valves are designed for external monitoring for safe, redundant operation of the valves. Such a monitoring system must be capable of inhibiting the operation of the valve. The RSe Series valves are constructed of redundant 5/2 spool type valves, and have an overall function of a single solenoid pilot-operated, spring return valve. Each single valve in the RSe Series is equipped with a PNP proximity sensor. Monitoring both of these sensors on each actuation and de-actuation of the RSe Series valve provides a diagnostic coverage of 99%. Monitoring of these sensors is to be done by an external monitoring system.

VALVE FEATURES

Redundant Control	Redundant control can achieve Category 4, PL e, when used with proper safety controls
External Monitoring	Each single valve in the RSe Series is equipped with a PNP proximity sensor. Monitoring both of these sensors on each actuation and de-actuation of the RSe Series valve provides a diagnostic coverage up to 99%. Monitoring of these sensors is to be done by an external monitoring system.
Spool Type Design	Redundant spool type valve with two operating solenoids that must be operated simultaneously in order to actuate the valve. In addition each valve element has a single, proximity sensor that is wired as a PNP type sensor for position sensing.
Valve Reset	Automatic reset by de-energizing the solenoids
Mounting	Base mounted – with G or NPT pipe threads. Inlet and outlet ports on both sides provide for flexible piping (plugs for unused ports included). Captive valve-to-base mounting screws.
SISTEMA Library	Available for download at rosscontrols.com

These valves are not designed for controlling clutch/brake mechanisms on mechanical power presses, see DM[®] Series D double valves for mechanical power press applications.

PRODUCT CREDENTIALS

Safety Category	DGUV (German Social Accident Insurance)	Declaration of Conformity			ISO Standard	CSA Certificate of Compliance	CRN Certification
		CE	UKCA	EAC			
 					ISO 13849-1:2015		Available for appropriately tested valves

Specifications

STANDARD SPECIFICATIONS				
GENERAL	Function		5/2 Normally Closed Valve,	
	Construction Design		Dual Spool and Sleeve	
	Actuation		Electrical – Solenoid Pilot Controlled Solenoid pilot operated with air assisted spring return. One solenoid per valve element (2 total) – both to be operated synchronously.	
	Mounting	Type	Base	
		Orientation	Any, preferably vertical	
	Connection		Threaded; G, NPT	
	Monitoring		Dynamic, cyclical, external with customer supplied equipment. Monitoring should check state of both valve position sensors with any and all changes in state of valve control signals.	
	Minimum Operation Frequency		Once per month, to ensure proper function	
Maximum Recommended Allowable Discordance Time		250 msec		
OPERATING CONDITIONS	Temperature	Ambient	40° to 120°F (4° to 50°C)	
		Media		
	Flow Media		Compressed air according to ISO 8573-1 Class 7:4:4	
	Pilot Supply		Internal or External	
	Operating Pressure	With Internal Pilot Supply	43 to 145 psig (3 to 10 bar)	
		With External Pilot Supply	0 to 145 psig (0 to 10 bar)	
	External Pilot Supply		Must be equal to or greater than inlet pressure	
	Pressure Sensors (2 per valve)		PNP solid state	
Pressure Sensors Current Consumption (each sensor)		<23mA (each without contacts)		
ELECTRICAL DATA	Solenoids	Operating Voltage		Power Consumption (each solenoid)
		24 volts DC		15 watts
		Rated for continuous duty		
		Design according to VDE 0580		
	Enclosure Rating		DIN 400 50 IP 65	
	Electrical Connection		DIN EN 175301-803 Form C	
	Proximity Sensors (2 per valve)		PNP	
	Current Consumption (each sensor)		<23mA	
CONSTRUCTION MATERIAL	Valve Body		Cast Aluminum	
	Poppet		Stainless Steel	
	Seals		Buna-N	
SAFETY DATA	Functional Safety Data	Category	CAT 4, PL e	
		B _{10D}	20,000,000	
		PFH _D	7.71x10 ⁻⁹	
		MTTF _D	301.9 (n _{op} : 662400)	
	Vibration/Impact Resistance		Tested to DIN EN 60068-2-6	
IMPORTANT NOTE: Please read carefully and thoroughly all of the CAUTIONS, WARNINGS on the inside back cover.				

Ordering Information

MODEL NUMBER CONFIGURATOR

5-Way 2-Position Valves

RSe

6

E

D

A10

A

3

1

P

Series

Monitoring

External

Reset Type

Automatic

Sensor

Sensor Output PNP

Type/Function

5/2

Thread

G

D

NPT

N

Base Port Size

Inlet	Outlet	
1/8	1/8	A10
1/4	1/4	B20
1/2	1/2	B40

Port Size	Flow C _v		Weight lb (Kg)
	2-1	4-1	
1/8	0.87	0.65	2.9 (1.3)
1/4	1.14	0.84	3.7 (1.7)
1/2	3.48	1.76	6.6 (2.99)

Simplified Valve Schematic

Valve Schematic

Solenoid & Sensor Pinouts

DIN EN 175301-803 Form C

Solenoid

3

1

2

1

2

3

1 - Positive

2 - Negative

3 - Ground

Sensor

4

1

3

1

4

3

1 - Common

2 - Normally Closed

3 - Not Used

4

M8

1

4

3

1

4

3

1 - Common

2 - Normally Closed

3 - Not Used

© 2022, ROSS CONTROLS® .All Rights Reserved.

ROSS CONTROLS®

DIMENSIONS

Inches (mm)

Port Size 1/8

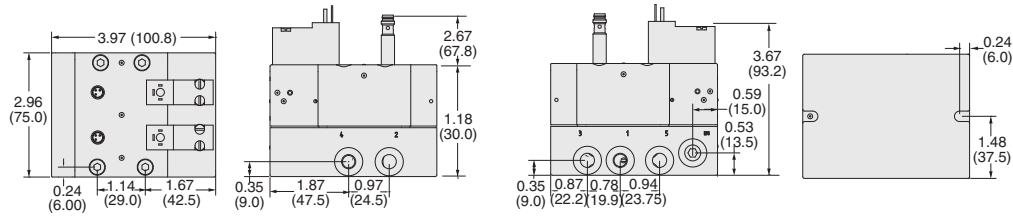

Port Size 1/4

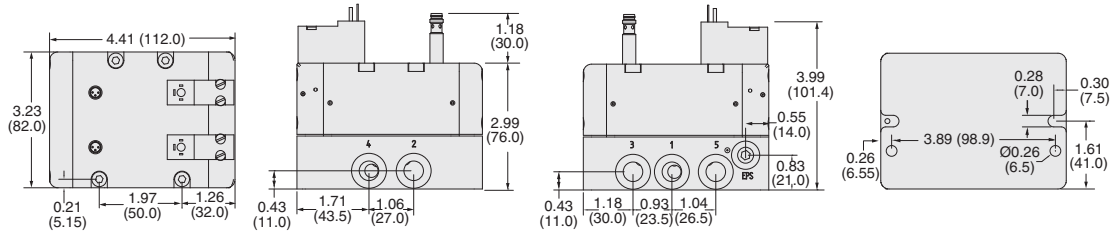

Port Size 1/2

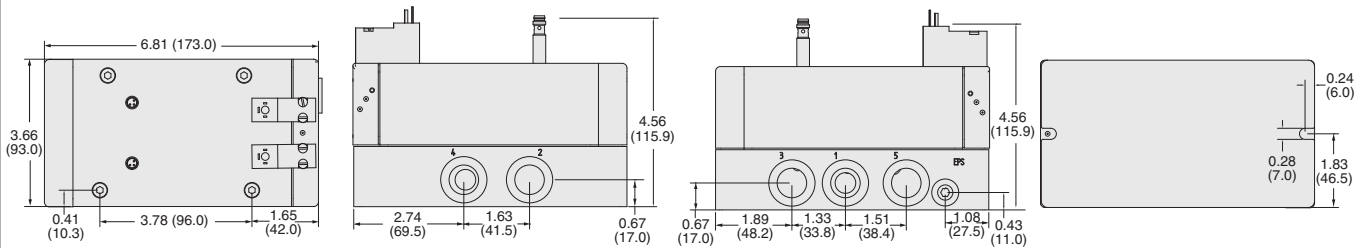

For additional information, and to assist you with piping and connectivity designs, our products are available in downloadable 2D drawings and 3D CAD models in a wide range of options including native formats, visit www.rosscontrols.com.

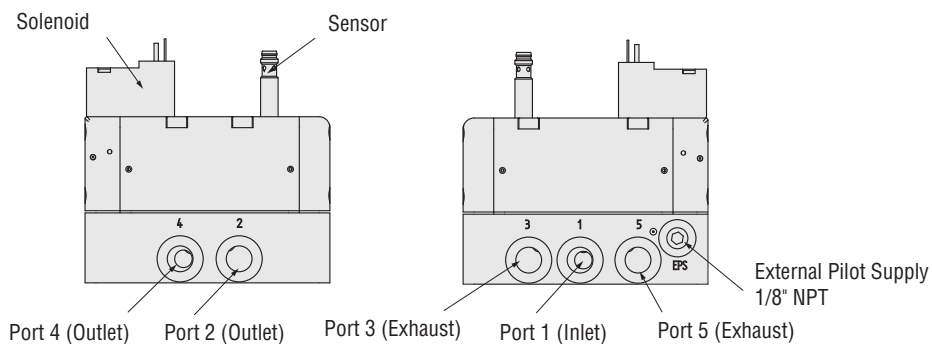

An integration Guide for RSe Series 5/2 valves is available from ROSS to provide information such as operation, monitoring, and integration into users control circuits, please visit www.rosscontrols.com.

Integration Guide - 5/2 RSe Series Safe Return Double Valves

Valve Technical Data

Application Examples

Typical Energy Saving Circuit

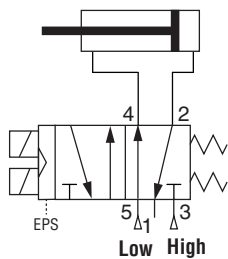

Accessories

ENERGY RELEASE VERIFICATION

Pressure Switches	Verification Type	Installation Location	Connector Type	Model Number	Port Size Thread	Factory Preset psi (bar)
	Electrical	Downstream	DIN EN 175301-803 Form A	586A86	1/8 NPT	5 (0.3) falling
Redundant Pressure Switch Assembly	Verification Type	Installation Location	Connector Type	Model Number	Port Size Thread	Factory Preset psi (bar)
	Electrical (Dual)	Downstream	DIN EN 175301-803 Form A	RC026-13	3/8 NPT	5 (0.3) falling

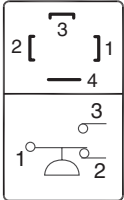
Pinout	
DIN EN 175301-803 Form A	
 <div> <p>1 - Common</p> <p>2 - Normally Closed</p> <p>3 - Normally Open</p> <p>4 - Ground (Not Used)</p> </div>	

Accessories

PREWIRED ELECTRICAL CONNECTORS

Prewired Connector Kit	Cable					Kit Number
	End 1	End 2	Connection Type	Quantity Included	Length meters (feet)	Without Light
	Connector	Cord				
	DIN EN 175301-803 Form C	Flying leads	Solenoid	2	2 (6.5)	2657B77
	M8	Flying leads	Sensor	2		

Prewired Connectors	Cable					Model Number	
	End 1	End 2	Quantity Included	Length meters (feet)	Cord Diameter	Without Light	Lighted Connector
	Connector	Cord					24 V DC
	DIN EN 175301-803 Form C	Flying leads	1	3 (10)	8-mm	2449K77	2450K77-W
	M8	Flying leads	1	2 (6.5)	–	249L74	–

ELECTRICAL CONNECTORS

Connectors	Connector			Model Number	
	Type	Connection	Quantity Included	Without Light	Lighted Connector
					24 V DC
	DIN EN 175301-803 Form C	Solenoid	1	2452K77	2453K77-W

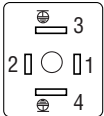
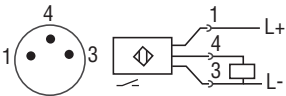
Connectors Pinout	
Solenoid	Sensor
DIN EN 175301-803 Form C	M8
<div></div> <div>1 - Brown 2 - Blue 3 - Green/Yellow (Ground) 4 - Green/Yellow (Ground)</div>	<div></div> <div>1 - Common 2 - Normally Closed 3 - Not Used</div>

EXHAUST SILENCERS						
Silencers	Port Size	Thread Type	Model Number		Flow Avg. C _v	Pressure Range psig (bar)
			R Thread	NPT Thread		
	1/8	Male	D5500A1003	5500A1003	1.2	0-290 (0-20) maximum
	1/4	Male	D5500A2003	5500A2003	2.1	
	1/2	Male	D5500A4003	5500A4003	4.7	

CAUTIONS, WARNINGS And STANDARD WARRANTY



ROSS OPERATING VALVE, ROSS CONTROLS®, ROSS DECCO®, and AUTOMATIC VALVE INDUSTRIAL, collectively the "ROSS Group".

PRE-INSTALLATION or SERVICE

1. Before servicing a valve or other pneumatic component, be sure all sources of energy are turned off, the entire pneumatic system is shut down and exhausted, and all power sources are locked out (ref: OSHA 1910.147, EN 1037).
2. All ROSS Group Products, including service kits and parts, should be installed and/or serviced only by persons having training and experience with pneumatic equipment. Because any product can be tampered with and/or need servicing after installation, persons responsible for the safety of others or the care of equipment must check ROSS Group Products on a regular basis and perform all necessary maintenance to ensure safe operating conditions.
3. All applicable instructions should be read and complied with before using any fluid power system to prevent harm to persons or equipment. In addition, overhauled or serviced valves must be functionally tested prior to installation and use. If you have any questions, call your nearest ROSS Group location.
4. Each ROSS Group Product should be used within its specification limits. In addition, use only ROSS Group components to repair ROSS Group Products.

WARNINGS:

Failure to follow these instructions can result in personal injury and/or property damage.

FILTRATION and LUBRICATION

1. Dirt, scale, moisture, etc., are present in virtually every air system. Although some valves are more tolerant of these contaminants than others, best performance will be realized if a filter is installed to clean the air supply, thus preventing contaminants from interfering with the proper performance of the equipment. The ROSS Group recommends a filter with a 5-micron rating for normal applications.
2. All standard ROSS Group filters and lubricators with polycarbonate plastic bowls are designed for compressed air applications only. Use the metal bowl guard, where provided, to minimize danger from high pressure fragmentation in the event of bowl failure. Do not expose these products to certain fluids, such as alcohol or liquefied petroleum gas, as they can cause bowls to rupture, creating a combustible condition and hazardous leakage. Immediately replace crazed, cracked, or deteriorated bowls.
3. Only use lubricants which are compatible with materials used in the valves and other components in the system. Normally, compatible lubricants are petroleum base oils with oxidation inhibitors, an aniline point between 180°F (82°C) and 220°F (104°C), and an ISO 32, or lighter, viscosity. Avoid oils with

phosphate type additives which can harm polyurethane components, potentially leading to valve failure which risks personal injury, and/or damage to property.

WARNINGS:

Failure to follow these instructions can result in personal injury and/or property damage.

AVOID INTAKE/EXHAUST RESTRICTION

1. Do not restrict air flow in the supply line. To do so could reduce the pressure of the supply air below minimum requirements for the valve and thereby causing erratic action.
2. Do not restrict a valve's exhaust port as this can adversely affect its operation. Exhaust silencers must be resistant to clogging and must have flow capacities at least as great as the exhaust capacities of the valves. Contamination of the silencer can result in reduced flow and increased back pressure.

WARNINGS: *Failure to follow these instructions can result in personal injury and/or property damage.*

SAFETY APPLICATIONS

1. Mechanical Power Presses and other potentially hazardous machinery using a pneumatically controlled clutch and brake mechanism must use a press control double valve with a monitoring device. A double valve without a self-contained monitoring device should be used only in conjunction with a control system which assures monitoring of the valve. All double valve installations involving hazardous applications should incorporate a monitoring system which inhibits further operation of the valve and machine in the event of a failure within the valve mechanism.
2. Safe Exhaust (dump) valves without a self-contained monitoring device should be used only in conjunction with a control system which assures monitoring of the valve. All Safe Exhaust valve installations should incorporate a monitoring system which inhibits further operation of the valve and machine in the event of a failure within the valve mechanism.
3. Per specifications and regulations, the ROSS L-O-X® and L-O-X® with EEZ-ON®, N06 and N16 Series operation products are defined as energy isolation devices, NOT AS EMERGENCY STOP DEVICES.

WARNINGS:

Failure to follow these instructions can result in personal injury and/or property damage.

STANDARD WARRANTY

All products sold by the ROSS Group are warranted for a one-year period [with the exception of Filters, Regulators and Lubricators ("FRLs") which are warranted for a period of seven (7) years] from the date of purchase. All products are, during their respective warranty periods, warranted to be free of defects in material and workmanship. The ROSS Group's obligation under this warranty is limited to repair, replacement or refund of the purchase price paid for products which the ROSS Group has determined, in its sole discretion, are defective. All warranties become void if a product has been subject to misuse, misapplication, improper maintenance, modification or tampering. Products for which warranty protection is sought must be returned to the ROSS Group freight prepaid.

THE WARRANTY EXPRESSED ABOVE IS IN LIEU OF AND EXCLUSIVE OF ALL OTHER WARRANTIES AND THE ROSS GROUP EXPRESSLY DISCLAIMS ALL OTHER WARRANTIES EITHER EXPRESSED OR IMPLIED WITH RESPECT TO MERCHANTABILITY OR FITNESS FOR A PARTICULAR PURPOSE. THE ROSS GROUP MAKES NO WARRANTY WITH RESPECT TO ITS PRODUCTS MEETING THE PROVISIONS OF ANY GOVERNMENTAL OCCUPATIONAL SAFETY AND/OR HEALTH LAWS OR REGULATIONS. IN NO EVENT IS THE ROSS GROUP LIABLE TO PURCHASER, USER, THEIR EMPLOYEES OR OTHERS FOR INCIDENTAL OR CONSEQUENTIAL DAMAGES WHICH MAY RESULT FROM A BREACH OF THE WARRANTY DESCRIBED ABOVE OR THE USE OR MISUSE OF THE PRODUCTS. NO STATEMENT OF ANY REPRESENTATIVE OR EMPLOYEE OF THE ROSS GROUP MAY EXTEND THE LIABILITY OF THE ROSS GROUP AS SET FORTH HEREIN.





AMERICAS	ROSS CONTROLS	USA	Tel: +1-248-764-1800	www.rosscontrols.com
	ROSS CONTROLS CANADA Ltd.	Canada	Tel: +1-416-251-7677	www.rosscanada.com
	ROSS DO BRASIL EIRELI	Brazil	Tel: +55-11-4335-2200	www.rosscontrols.com.br
EUROPE	ROSS EUROPA GmbH	Germany	Tel: +49 (0)6103-7597-100	www.rosseuropa.com
	ROSS FRANCE SAS	France	Tel: +33-(0)1-49-45-65-65	www.rossfrance.com
	ROSS PNEUMATROL Ltd.	United Kingdom	Tel: +44 (0)1254 872277	www.rossuk.co.uk
ASIA & PACIFIC	ROSS CONTROLS INDIA Pvt. Ltd.	India	Tel: +91-44-2624-9040	www.rosscontrolsindia.com
	ROSS CONTROLS (CHINA) Ltd.	China	Tel: +86-21-6915-7961	www.rosscontrolschina.com
	ROSS ASIA K.K.	Japan	Tel: +81-42-778-7251	www.rossasia.co.jp
	AUTOMATIC VALVE INDUSTRIAL LLC	USA	Tel: +1-248-474-6700	www.automaticvalve.com
	ROSS DECCO COMPANY	USA	Tel: +1-248-764-1800	www.rossdecco.com
	ROSS PNEUMATROL Ltd.	United Kingdom	Tel: +44 (0)1254 872277	www.pneumatrol.com
	manufactIS GmbH	Germany	Tel: +49 (0)2013-16843-0	www.manufactis.net

Full-Service Global Locations

There are ROSS Distributors Throughout the World

To meet your requirements across the globe, ROSS distributors are located throughout the world. Through ROSS or its distributors, guidance is available for the selection of ROSS products, both for those using fluid power components for the first time and those designing complex systems.

Other literature is available for engineering, maintenance, and service requirements.

If you need products or specifications not shown in this catalog, please visit ROSS' website, contact ROSS or your ROSS distributor. The ROSS Support Team will be happy to assist you in selecting the best product for your application.

For a current list of countries and local distributors, visit ROSS' at www.rosscontrols.com.